

B. Braun Nutritub® ENFit®

The Future is Here and it's Safe

To enhance patient safety, B. Braun has been collaborating with the Global Enteral Device Supplier Association (GEDSA) to support the introduction and adoption of a new ISO standard for small-bore connectors: ENFit®.

ENFit®

The new ENFit® standard design for enteral application systems is defined in the ISO 80369-3 series, establishing ENFit® as the new international standard design for enteral patient-access connections. The ENFit® connector system is specifically designed for enteral nutrition administration devices at the patient end, promoting enhanced patient safety and preventing unintentional connections between enteral and intravenous systems.

The female ENFit® connector at the patient-end of the administration set will only connect to the male patient-access feeding tube port. Enteral syringes with a female ENFit® connector will only fit to second access stopcocks on application sets or feeding tubes with a male ENFit® connector. With Nutritub® ENFit® the B. Braun ENFit® portfolio is now complete.

USER BENEFITS

- Dedicated enteral connectors minimize risk of misconnections
- "Lock and Key" feature ensures secure connection
- Purple color coding allows faster identification of enteral devices
- One system for all major application ways and diet containers



Nutritub® Gastral ENFit® Paed



Nutritub® Gastral ENFit®



Nutritub® Intestinal ENFit®

The new Nutritub® ENFit® range for gastral and intestinal application

| Product | Size (CH) | Length (cm) | Stylet | Art. No. |
|---|-----------|-------------|--------|----------|
| Nutritub® Gastral ENFit® | | | | |
| Nutritub® Gastral ENFit® Paed CH5 | 5 | 50 | - | 9246508 |
| Nutritub® Gastral ENFit® Paed CH6 | 6 | 60 | - | 9246511 |
| Nutritub® Gastral ENFit® CH8, w/o stylet | 8 | 80 | - | 9246535 |
| Nutritub® Gastral ENFit® CH10, stylet | 10 | 110 | ■ | 9246512 |
| Nutritub® Gastral ENFit® CH12, stylet | 12 | 110 | ■ | 9246543 |
| Nutritub® Gastral ENFit® CH14, stylet | 14 | 110 | ■ | 9246513 |
| Nutritub® Gastral ENFit® CH14, w/o stylet | 14 | 110 | - | 9246514 |
| Nutritub® Gastral ENFit® CH16, stylet | 16 | 110 | ■ | 9246515 |
| Nutritub® Gastral ENFit® CH16, w/o stylet | 16 | 110 | - | 9246516 |
| Nutritub® Gastral ENFit® CH18, stylet | 18 | 110 | ■ | 9246518 |
| Nutritub® Gastral ENFit® CH18, w/o stylet | 18 | 110 | - | 9246519 |
| Nutritub® Intestinal ENFit® | | | | |
| Nutritub® Intestinal ENFit® CH8, stylet | 8 | 125 | ■ | 9246578 |
| Nutritub® Intestinal ENFit® CH12, stylet | 12 | 125 | ■ | 9246586 |

A Safety System for Different Applications

Connecting what belongs together



Gravity application

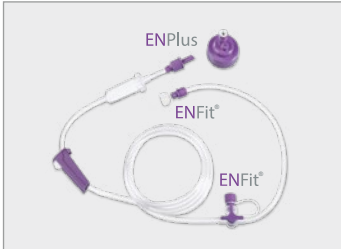

Enteral pump application (Enteroport® plus)

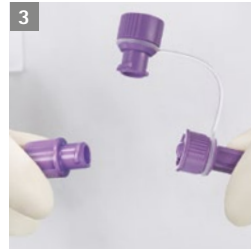
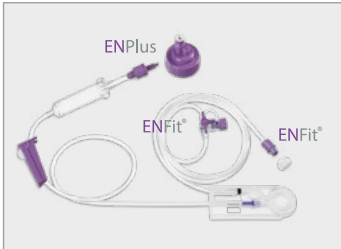

Universal pump application (Infusomat® Space)

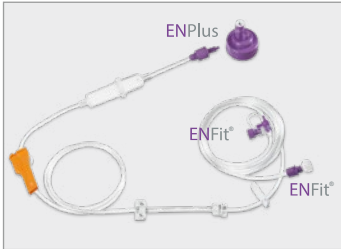

Universal pump application (Perfusor® Space)

